



## Product Features

LTECH

- 2 in 1 function: RF wireless control and PWM power output.
- Power output, lamps can be connected directly, easy and convenient.
- With 2 functions: dimming and switch.
- Touch panel can be controlled by remote directly or smart phone if add a gateway.

## Technical Specs

E61 Dimming knob panel

Input voltage:	12-24Vdc	Working temp.:	-10°C~55°C
Input signal:	RF 2.4GHz	Dimensions:	L86×W86×H36(mm)
Output current :	6A×1CH	Package size:	L113×W112×H50(mm)
Output power:	0~72W...144W	Weight(G.W.):	235g
Protection:	Short circuit / over current		

## Key Functions



Knob

- \* Clockwise spin the knob, brightness increases.
- \* Counterclockwise spin the knob, brightness decreases. Turn off the panel if you spin to the leftmost end (a click can be heard).

## Terminals

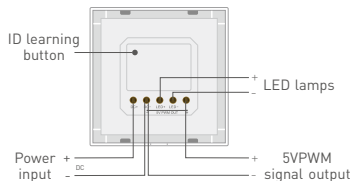

2

## Installation Instruction

LTECH

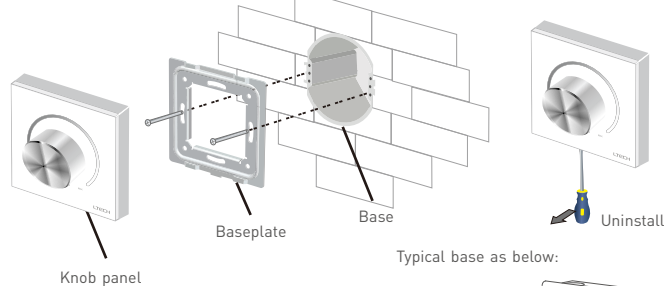

Typical base as below:

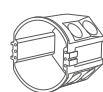

European style

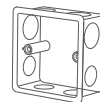

86 size



## Product Size

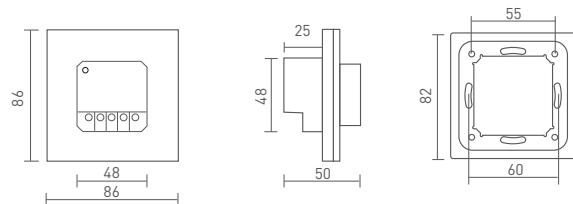

Unit: mm









3

## Application Composition

-  + 

Knob panel      LED strip
-  +  + 

Knob panel      Remote      LED strip
-  +  + 

Knob panel      WiFi master controller      LED strip
-  +  +  + 

Knob panel      WiFi master controller      Remote      LED strip

LTECH

## Wiring Diagram

Connect with 12V strip, Max. 72W; connect with 24V strip, Max. 144W.

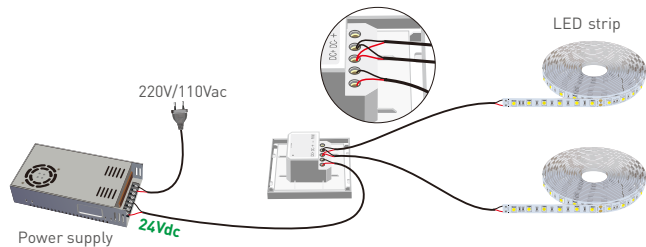

LTECH

## PWM Signal Output

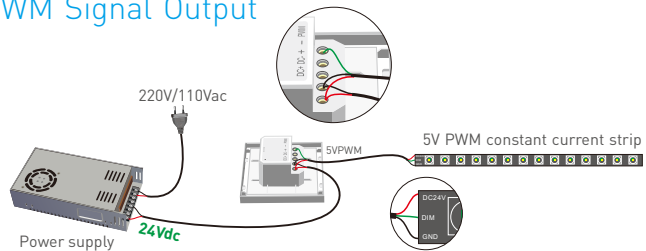

## Match Code Sequence

LTECH

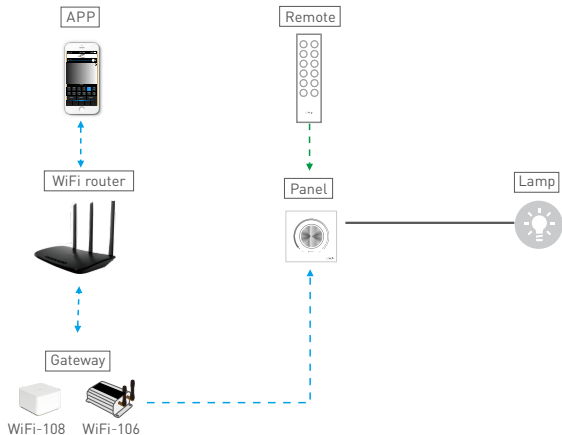

\* PS: No WiFi router needed when WiFi-106 gateway work with phones directly.

### Match Code Sequence

1. Gateway match up with panel, which enables the smart phone to control lamps via gateway.
2. Remote match up with panel, which enables remote to control lamps.

## Match Code between Panel & Remote

LTECH

1. Short press "ID learning button" on E61, the lamps flicker.

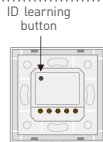

2. Hold down On/Off key on F1, or hold down the matching zone's On & Off keys on F5 simultaneously, if the lamp flicker quickly then back to normal, match successfully.



- \* Exit match status automatically if over 15 seconds.
- \* One E61 can be matched with max 10 remotes.

## Match Code between Panel & Gateway

1. Turn on APP, enter "zone set" interface.



2. Click the right top "MATCH" key, then operate following the prompts.



## Clear Code

Long press "ID learning button" on E61 for 10s until the lamps flicker 5 times, clear code successfully.

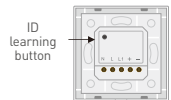

- \* No further notice if any changes in the manual. Product function depends on the goods. Please feel free to contact our official distributor if any question.